



wirefield

# PROLED50 B11J

**50,000 hrs**  
**L80/B10**

**TRACK  
MOUNTED**

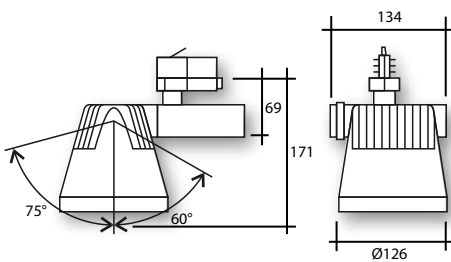

## Technical Specification

- Powder coated die cast aluminium body.
- MacAdam 2 SDCM.
- Global 3-circuit track adaptor.
- RAL9006 – Silver, RAL9016 – White, RAL9005 – Black.
- Integral adjustable driver.
- Citizen 6th Generation LED COB.
- IP20.

## Features

Wattage	18w to 29w
Lumens per Watt	Up to 115
CRI	90+ (Below BBL @ 3000K)
L**B**	50,000 hours L80 B10
Driver	Adjustable Fixed Output / DALI
Colour Temperature	4000k

*LIGHTING INNOVATION FOR RETAIL APPLICATIONS*

## Product Specification

COB38	CRI90+ 3000K Below BBL	CRI90+ 4000K	Reflector Options	Colour Options
25w (650ma)	2800lm	3000lm	10° 24° 30° 50°	Silver, White, Black
33W (850ma)	3475lm	3700lm	10° 24° 30° 50°	Silver, White, Black
43w (1050ma)	4075lm	4350lm	10° 24° 30° 50°	Silver, White, Black
<b>COB48</b>				
25w (650ma)	3000lm	3225lm	20° 40° 60°	Silver, White, Black
40w (1050ma)	4575lm	4900lm	20° 40° 60°	Silver, White, Black
55w (1400ma)	5750lm	6125lm	20° 40° 60°	Silver, White, Black

## LED Options

### Additional Options:

CRI80+ 2700K, 3000K, 4000K, 5000K

CRI90+ 2700K Below BBL, 3500K Below BBL

4000K Brilliant Vivid

Meat 2000K

Bakery 2400K

Full photometry and LDT files available on request

Designed & manufactured to comply with EN 60598 and are CE certified

*LIGHTING INNOVATION FOR RETAIL APPLICATIONS*