

Completely manufactured in the UK, Bulk LED was the first luminaire on the market to feature a Soft Arc Linear Lens Diffuser designed to provide maximum spacings between emergency luminaires. Even today, very few products are able to meet Bulk LED's optical performance.

The Bulk LED can be fitted with a self adhesive legend SAL 1 kit to create an exit sign.

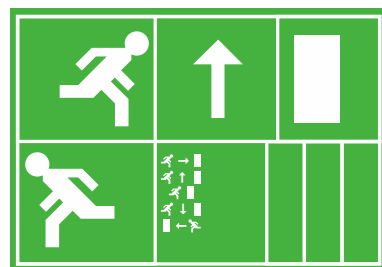

/SAL1: Universal self adhesive Exit Kit

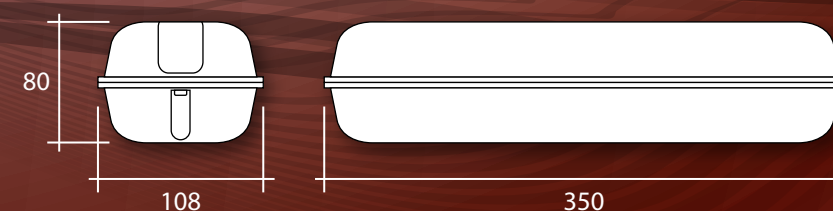

Semi-Recess Cut Out: 330 x 90

### Product Specification

- Certified ingress protection to IP65
- Polycarbonate enclosure. These include a screw fixing diffuser located with brass threaded inserts
- Centre rear besa entry and 20mm conduit knockouts at each end
- Hinged steel gear tray for ease of installation
- Available for maintained or non-maintained operation

### Optional Features

(Add suffix to order code)

- /SAL1: Universal self adhesive Exit Kit
- /VR: Anti-tamper Screws
- /O: Opal Diffuser
- /AD: Intelligent Addressable Luminaire
- /ST: Self Testing Luminaire
- /TS: Push to Test Switch

### Lamp Options



LED: Light Emitting Diode

### Order Codes

Including Lamps

#### MAINTAINED

Order Code	Watt	L	W	D	Lamp
BULK/LED/E3M	2	350	108	80	LED

#### NON-MAINTAINED

Order Code	Watt	L	W	D	Lamp
BULK/LED/E3N	2	350	108	80	LED

Example order code:

BULK/LED/E3M – A 2 watt Bulk LED, IP65 bulkhead 3 hour maintained operation.

### Applications:

- Exterior of final Exit
- Meter cupboard

